



1 bed apartment to buy in DH2

Abington, Ouston, Chester Le Street,
Durham, DH2 1QZ

£23,000 Starting Bid

 x1  x1  x1

Tenure

Leasehold

Allocated parking

Property features

- ✓ Ideal First Time Buy OR Investment Opportunity
- ✓ Ground Floor Apartment
- ✓ One Bedroom
- ✓ Modern Kitchen
- ✓ EPC Rating D

Key Information

- ✓ Council Tax: Band A
- ✓ EPC Rating: D
- ✓ Heating supply: Air Source Heat Pump

Description

****ONE BEDROOM**GROUND FLOOR APARTMENT**MODERN KITCHEN**SOUGHT AFTER AREA**POTENTIAL RENTAL INCOME ONF £450/500 PCM****

Pattinson Estate Agents are happy to welcome to the market a this deceptively spacious one bed apartment, which is located on the ground floor and is located in the popular area of Ouston, Chester Le Street. Perfectly situated with easy access to popular local schools, local amenities, good public transport and great for commuting via the A1(M). Also within a short drive to 'The Galleries' Shopping Centre, Chester Le Street Train station, Sunderland & Durham City Centres.

This well presented apartment is generously proportioned throughout and briefly consists:- Private apartment entrance/hallway, lounge, modern kitchen, a double bedroom and three piece bathroom. Externally there are communal gardens, the apartment also benefits from double glazed windows, new electric water boiler and new electrical sockets throughout.

Early viewings come highly recommend to appreciate the standard and location of this property. Please call our Houghton office to arrange viewings.

Council Tax Band: A

Tenure: Leasehold

Length of Lease: 100

Annual Service Charge Amount: £1,200.00

Service Charge Review Period: Year

Price: Starting Bid £23,000

Property Type: Apartment

Parking: Allocated

Heating: Air Source Heat Pump

Apartment/Entrance

Private apartment entrance leading to the hallway, which gives access to the lounge and bathroom.



Lounge

3.05m x 4.02m (10'0" x 13'2")

Spacious lounge with carpet flooring, a radiator and a double glazed rear aspect window.



Kitchen

1.55m x 3.15m (5'1" x 10'4")

Modern kitchen benefiting from a range of upper and lower units with contrasting work surfaces, stainless steel sink unit, plumbing for a washing machine and a integrated oven with a ceramic hob. Tiled flooring, a radiator and a double glazed front aspect window.



Bedroom

2.51m x 3.04m (8'2" x 9'11")

Double bedroom with fitted wardrobes, carpet flooring, a radiator and a double glazed window.



Bathroom

Three piece bathroom benefiting from a panelled bath with overhead shower, hand wash basin and W.C. Vinyl flooring, a mixture of tiled and UPVC cladded walls, a radiator and a double glazed window.



External

Externally there are communal gardens surrounding the complex.



Approx Gross Internal Area
29 sq m / 317 sq ft

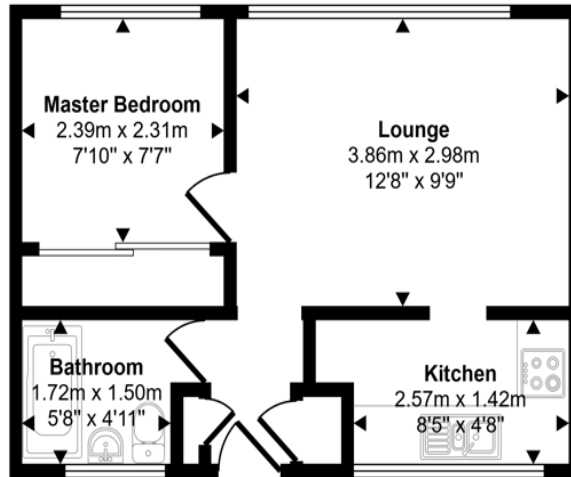

Floorplan

This floorplan is only for illustrative purposes and is not to scale. Measurements of rooms, doors, windows, and any items are approximate and no responsibility is taken for any error, omission or mis-statement. Icons of items such as bathroom suites are representations only and may not look like the real items. Made with Made Snappy 360.

Energy Efficiency Rating		
	Current	Potential
<i>Very energy efficient - lower running costs</i>		
(92-100) A		
(81-91) B		
(69-80) C		74
(55-68) D	68	
(39-54) E		
(21-38) F		
(1-20) G		
<i>Not energy efficient - higher running costs</i>		
England, Scotland & Wales	EU Directive 2002/91/EC	

Abington, Ouston, Chester Le Street, Durham, DH2 1QZ

Contact your local branch today for more information on this property:
G&T Properties Dudley Road, Brierley Hill, West Midlands, DY5 1HA,
<https://www.gandtproperties.co.uk/>

These particulars, whilst believed to be accurate are set out as a general outline only for guidance and do not constitute any part of an offer or contract. Intending purchasers should not rely on them as statements of representation of fact, but must satisfy themselves by inspection or otherwise as to their accuracy. No person in this firm's employment has the authority to make or give any representation or warranty in respect of the property.

