



3 bed maisonette to buy in CR4

Heaton Road, Mitcham, CR4 2BU

£325,000 Starting Bid

🏠 x3 🚗 x1 🚲 x1

Tenure

Share Of Freehold

On Street parking

Property features

- ✓ Being Sold via Secure Sale online bidding. Terms and Conditions
- ✓ No Onward Chain
- ✓ Share of Freehold
- ✓ Three Bedrooms
- ✓ EPC Rating F

Key Information

- ✓ Council Tax: Band C
- ✓ EPC Rating: F
- ✓ Heating supply: Gas
- ✓ Electric supply: National Grid
- ✓ Water supply: Direct mains water
- ✓ Mobile signal: Good

Description

A share of freehold, three-bedroom first floor maisonette, offered to the market chain-free and requiring substantial renovation throughout.

This is a fantastic opportunity for buyers with vision to transform a generously sized property into a bespoke home.

The layout comprises three bedrooms, a spacious reception room, separate kitchen, and a family bathroom. While the property is in need of complete modernisation, it offers immense potential to reconfigure and add value, subject to the usual consents.

Located on Heaton Road, a quiet residential turning just off Figges Marsh, the property is ideally situated for the open green spaces nearby, as well as the shops, eateries, and amenities along London Road. Excellent transport connections are within easy reach, with Tooting Mainline Station (Thameslink) offering frequent services into Central London and beyond.

Council Tax Band: C

Tenure: Share Of Freehold

Length of Lease: 137

Annual Ground Rent Amount: £18.00

Price: Starting Bid £325,000

Property Type: Maisonette

Parking: On Street, Permit Parking

Year built: 1910

Construction materials: Brick and block

Risk of floods and or erosion: No

Flooded in last 5 years: No

Flood defences: No

Planning permissions or proposals for development: No

Coalfield or mining area: No

Listed property: No

Conservation area: No

Public rights of way: No

Adaptions for accessibility: Yes

Restrictions: No

Heating: Gas

Electric: National Grid

Water: Direct mains water

Water meter: No

Sewerage: Standard UK domestic

Air conditioning: No

Mobile signal coverage: Good

Heaton Road, Mitcham, CR4

Approximate Area = 734 sq ft / 68.1 sq m
For identification only - Not to scale

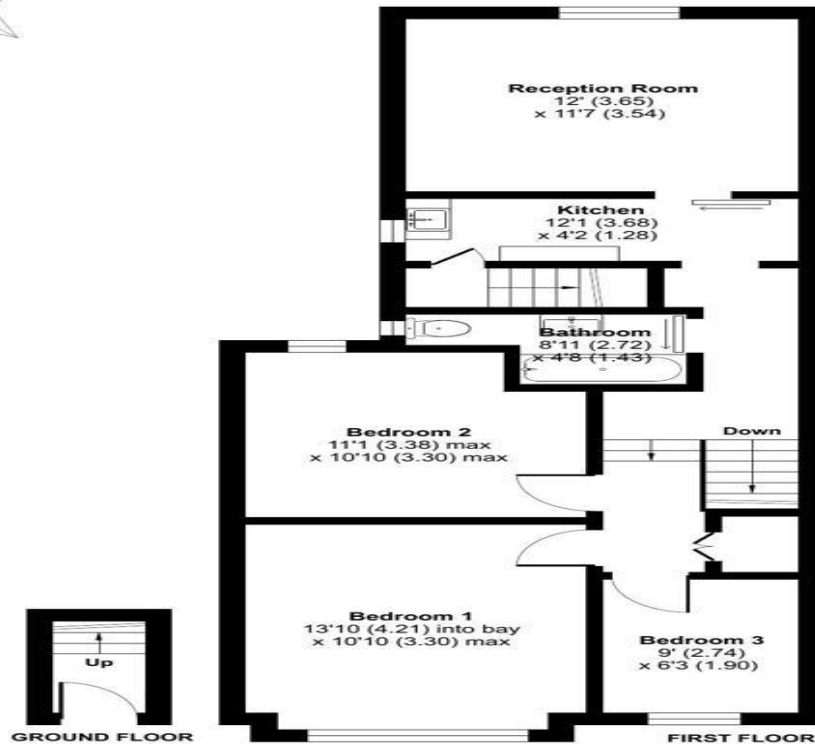

Floor plan produced in accordance with RICS Property Measurement 2nd Edition, incorporating International Property Measurement Standards (IPMS2 Residential). © nichecom 2025. Produced for Goodfellows Estate Agents. REF: 1305972

Energy Efficiency Rating		
	Current	Potential
<i>Very energy efficient - lower running costs</i>		
(92-100) A		
(81-91) B		
(69-80) C		
(55-68) D		65
(39-54) E	38	
(21-38) F		
(1-20) G		
<i>Not energy efficient - higher running costs</i>		
England, Scotland & Wales	EU Directive 2002/91/EC	

Heaton Road, Mitcham, CR4 2BU

Contact your local branch today for more information on this property:
G&T Properties Dudley Road, Brierley Hill, West Midlands, DY5 1HA,
<https://www.gandtproperties.co.uk/>

These particulars, whilst believed to be accurate are set out as a general outline only for guidance and do not constitute any part of an offer or contract. Intending purchasers should not rely on them as statements of representation of fact, but must satisfy themselves by inspection or otherwise as to their accuracy. No person in this firm's employment has the authority to make or give any representation or warranty in respect of the property.

