

**ELEVATIONS PROPOSED**

SCALE: 1:50@A1

CONTRACTORS MUST CHECK ALL DIMENSIONS  
CHECK WORK FROM SQUARE DIMENSIONS  
DIMENSIONS MUST BE REPORTED IMMEDIATELY TO THE ARCHITECT  
TO AVOID PROBLEMS BEFORE PROCEEDING  
**IF IN DOUBT - ASK**

DATE	REVISION
20.03.24	<b>A</b> PROPOSED FOOTPRINT, SCALE AND FINISHES REVISED SIGNIFICANTLY AND PULLED AWAY FROM EXISTING CONCRETE TO PREVIOUSLY PROPOSED APPLICATION TO PART 101 WITH SOME CHANGES TO FINISHES

**PROPOSED FINISHES**

**EXTERNAL WALLS:**  
NATURAL LOCAL STONEMWORK FINISH -  
COLOUR - BROWN/BEGE TO MATCH  
SURROUNDINGS WITH RED BRICK  
QUOINING.

**ROOF FINISHES:**  
FIRST SELECTION NATURAL SLATE -  
COLOUR - BLUE/GREY

**WINDOWS:**  
POWDERCOATED ALUMINIUM -  
COLOUR - WHITE

**DOORS:**  
POWDERCOATED ALUMINIUM -  
COLOUR - GREY

**RAINFATHER COODS:**  
POWDERCOATED ALUMINIUM -  
COLOUR - BLACK

**BILLY LEWIS ARCHITECTS**  
No. 1 Victoria Road, Malpas Road, Truro, Cornwall, TR1 1GH  
01872 212110 | billy.lewis@billylewis.co.uk  
www.billylewis.co.uk

CLIENT: MR & MRS WEDDEN  
PROJECT: NEW BUILDING TO GARDEN OF  
TREVEMPER LODGE, NEWQUAY, TR8  
DRAWING: PLANNING SERIES  
ELEVATIONS AS PROPOSED

SCALE: 1:50 @A1 | DRAWN: JM | CHECKED: BS | DIRECTOR: JM  
DATE: 22.03.24

PROJECT NUMBER: 23021.3.006 | DRAWING NUMBER: A

SCALE IN METRES 1:50 @ A1

## Land & Development in TR8

Trevemper, Trevemper, Newquay,  
Cornwall, TR8 4QD

**£70,000** Starting Bid

Tenure  
**Freehold**

Residents parking

## Property features

- ✓ Planning GRANTED - PA24/02470
- ✓ Priced to Sell
- ✓ Immediate 'exchange of contracts' available

## Description

For sale via secure sale online bidding - terms and conditions apply.

We are delighted to bring to the market the opportunity to acquire this plot with planning permission granted for a two bedroom detached cottage, planning reference number PA24/02470.

This is a fantastic opportunity for the next purchaser and we encourage registering your interest early to avoid disappointment.

Please note the entrance is shared access and parking is designated to the allocated spaces.

Please note we have not inspected this property.

Price: Starting Bid £70,000

Property Type: Land & Development

Business Type: Residential Investments

Parking: Residents

## **Location**

The plot is located in Trevemper, on the southern outskirts of Newquay, just 1.5 miles from the town centre.

---

## **Site details**

Planning permission granted for a new dwelling, two bedroom detached cottage.

---

## **Tenure**

Freehold, subject to title split.

---

## **Additional Information**

For further information please contact our office directly on 0191 737 1154, or alternatively via email on [commercial@pattinson.co.uk](mailto:commercial@pattinson.co.uk). With regards to viewing subject property, this is to be done strictly by appointment.

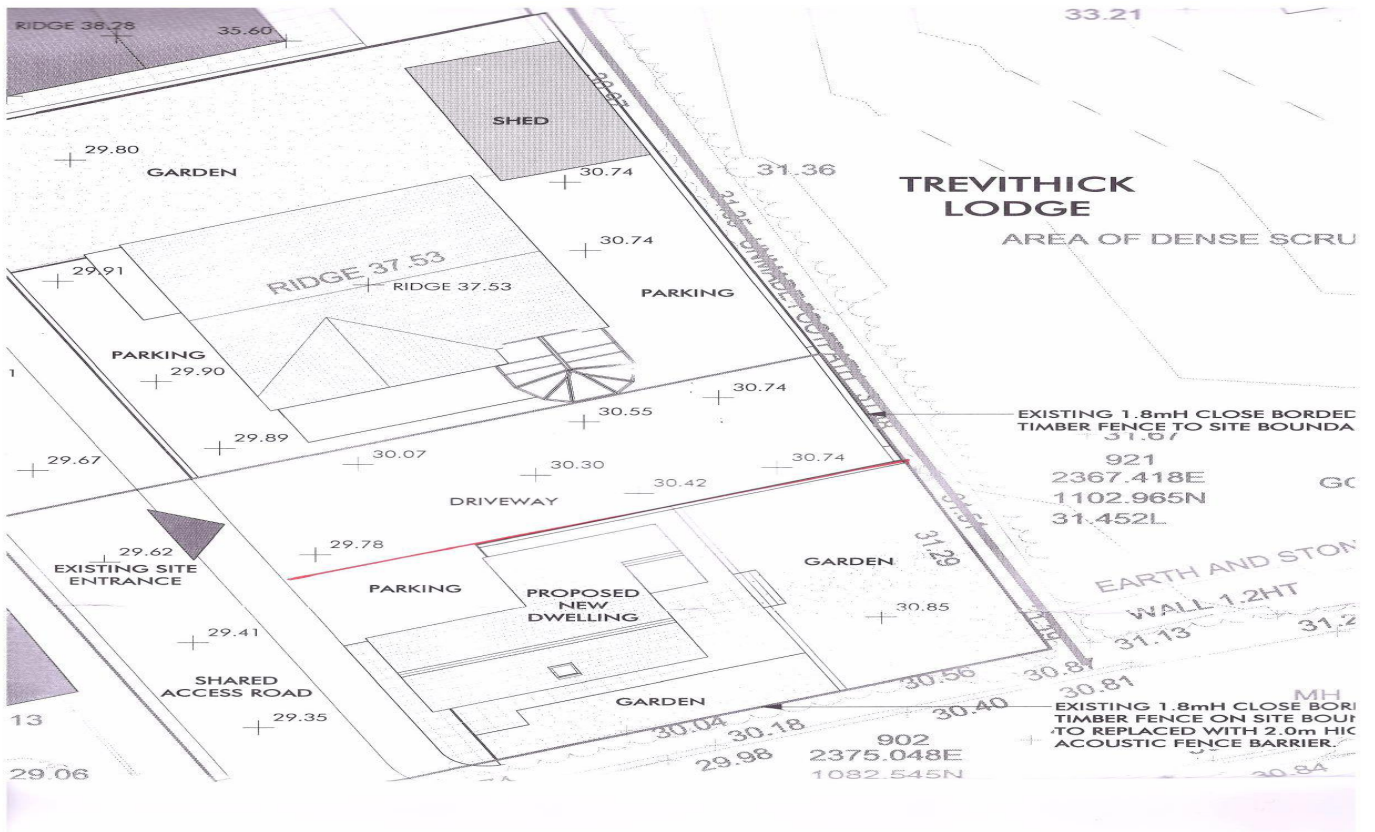

Trevemper, Trevemper, Newquay, Cornwall, TR8 4QD

Contact your local branch today for more information on this property:  
**G&T Properties Dudley Road, Brierley Hill, West Midlands, DY5 1HA,**  
<https://www.gandtproperties.co.uk/>

These particulars, whilst believed to be accurate are set out as a general outline only for guidance and do not constitute any part of an offer or contract. Intending purchasers should not rely on them as statements of representation of fact, but must satisfy themselves by inspection or otherwise as to their accuracy. No person in this firm's employment has the authority to make or give any representation or warranty in respect of the property.

