



3 bed terraced house to buy in

Cavendish Gardens, Ashington, Ashington,
Northumberland, NE63 0EW

£50,000 Starting Bid

🏠 x3 🚿 x1 🚻 x1

Tenure

Freehold

Allocated parking

Property features

- ✓ Three Bedrooms
- ✓ Terrace House
- ✓ D/G & GCH
- ✓ Requires Updating
- ✓ Garden to front, Yard to rear

Key Information

- ✓ Council Tax: Band A
- ✓ Heating supply: Gas
- ✓ Electric supply: National Grid
- ✓ Water supply: Direct mains water

Description

TO BE SOLD via ONLINE AUCTION. Fees apply.

*** MID TERRACED HOUSE *** REQUIRES UPDATING*** THREE BEDROOM *** GARDEN & YARD***

Offered to the market for sale this three bedroom mid terrace property located on Cavendish Gardens on Ashington.

Located close to the town centre and all amenities including shops, schools and transport links with easy access to the A189 spine road.

Accommodation briefly comprises:- lounge, kitchen, bathroom, to the first floor there are three bedrooms. Externally there is a small yard to the rear with outhouses and garden to the front.

EPC:TBC

Council Tax Band: A

Tenure: Freehold

Price: Starting Bid £50,000

Property Type: Terraced House

USPs: Requires work

Parking: Allocated

Heating: Gas

Electric: National Grid

Water: Direct mains water

Sewerage: Standard UK domestic

Entrance Hallway

Via double glazed door
-Stairs to first floor



Living Room

3.55m x 4.397.00m (11'7" x 14'425'10")

Double glazed window to front
-Radiator
-Under stairs cupboard
-Storage cupboard



Additional Image



Kitchen

4.47m x 2.08m (14'7" x 6'9")

Double glazed window and door to rear
-Fitted base units with work tops
-Plumbed for washing machine
-Cooker point
-Part tiled walls
-Radiator



Additional Image 1



Additional Image 2



Bathroom

- Double glazed window
- Panelled bath
- Low level wc
- Pedestal wash hand basin
- Tiled walls



Bedroom 1

4.52m x 3.15m (14'9" x 10'4")

- 2 x double glazed windows to front
- Radiator



Bedroom 2

2.20m x 3.39m (7'2" x 11'1")

- Double glazed window
- Radiator



Bedroom 3

2.13m x 2.21m (6'11" x 7'3")

- Double glazed window
- Radiator



Rear External

Enclosed rear yard with outhouses



Front Garden

Mainly laid to lawn with mature hedges



Approx Gross Internal Area
64 sq m / 687 sq ft

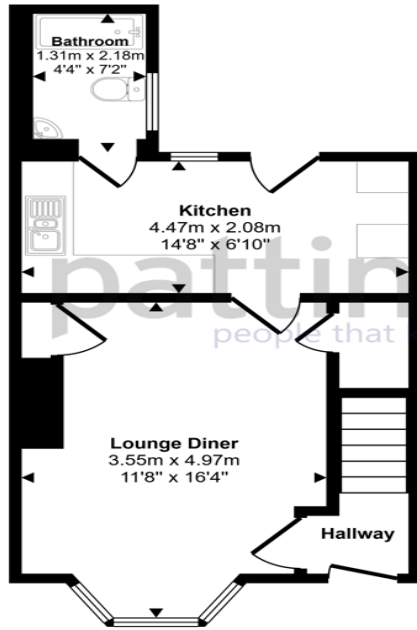

Ground Floor
Approx 34 sq m / 362 sq ft

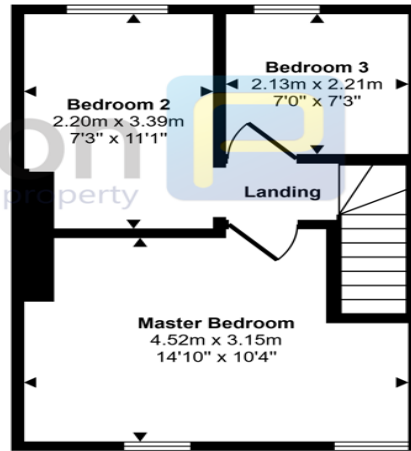

First Floor
Approx 30 sq m / 325 sq ft

This floorplan is only for illustrative purposes and is not to scale. Measurements of rooms, doors, windows, and any items are approximate and no responsibility is taken for any error, omission or mis-statement. Icons of items such as bathroom suites are representations only and may not look like the real items. Made with Made Snappy 360.

Cavendish Gardens, Ashington, Ashington, Northumberland, NE63 0EW

Contact your local branch today for more information on this property:
G&T Properties Dudley Road, Brierley Hill, West Midlands, DY5 1HA,
<https://www.gandtproperties.co.uk/>

These particulars, whilst believed to be accurate are set out as a general outline only for guidance and do not constitute any part of an offer or contract. Intending purchasers should not rely on them as statements of representation of fact, but must satisfy themselves by inspection or otherwise as to their accuracy. No person in this firm's employment has the authority to make or give any representation or warranty in respect of the property.

