



## Offices in NE6

Headlam Street, Byker, Newcastle upon Tyne, Tyne and Wear, NE6 2LG

**£140,000** Starting Bid

Tenure

**Leasehold**

On Street parking

## Property features

- ✓ Vacant Commercial Property
- ✓ Previously A Taxi Office
- ✓ Flexible Layout
- ✓ Suitable For A Variety Of Uses
- ✓ Prepared For Personalisation

## Description

For sale via secure sale online bidding - terms and conditions apply.

Presenting a unique opportunity to acquire a vacant commercial property at 12 Headlam Street, previously used as a taxi office. This property is situated in the heart of Byker. The property offers a flexible layout suitable for various business ventures, including office space, retail, or service-oriented enterprises. Currently vacant, the property is a blank canvas, ready for customisation to suit your business requirements.

Headlam Street is well-connected, with multiple bus stops within a short walking distance, facilitating easy commutes for both staff and customers.

Price: Starting Bid £140,000

Property Type: Offices

Business Type: Other/Unspecified

Internal Size: 1373 Square Feet

External Size: 1373 Square Feet

Parking: On Street

## **Location**

The subject is located on Headlam Street, Byker, behind shop units that front onto Shields Road and in the vicinity of the leisure pool.

Byker is an established residential and commercial area located around two miles east of Newcastle City Centre and provided with a range of local services and facilities.

---

## **Tenure**

Long leasehold of 999 years from 18 November 1991. Title number TY267745.

---

## **EPC**

Rating B. Available upon request.

---

## **Additional Information**

For further information please contact our office direct on 0191 737 1154, or alternatively via e-mail on [commercial.ne@pattinson.co.uk](mailto:commercial.ne@pattinson.co.uk). With regards to viewing the subject property, this is to be done strictly by appointment through Keith Pattinson Commercial department. Please contact us to arrange an internal inspection, or to register your interest.

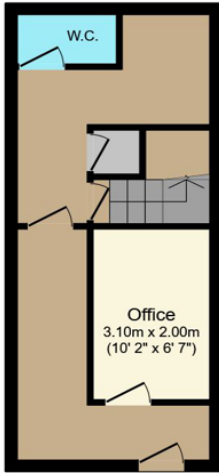

### Ground Floor

Floor area 26.7 m<sup>2</sup>  
(288 sq.ft.)



### First Floor

Floor area 100.8 m<sup>2</sup> (1,085 sq.ft.)

**TOTAL: 127.5 m<sup>2</sup> (1,373 sq.ft.)**

This floor plan is for illustrative purposes only. It is not drawn to scale. Any measurements, floor areas (including any total floor area), openings and orientations are approximate. No details are guaranteed, they cannot be relied upon for any purpose and do not form any part of any agreement. No liability is taken for any error, omission or misstatement. A party must rely upon its own inspection(s). Powered by [www.Propertybox.io](http://www.Propertybox.io)

Headlam Street, Byker, Newcastle upon Tyne, Tyne and Wear, NE6 2LG

Contact your local branch today for more information on this property:  
**G&T Properties Dudley Road, Brierley Hill, West Midlands, DY5 1HA,**  
<https://www.gandtproperties.co.uk/>

These particulars, whilst believed to be accurate are set out as a general outline only for guidance and do not constitute any part of an offer or contract. Intending purchasers should not rely on them as statements of representation of fact, but must satisfy themselves by inspection or otherwise as to their accuracy. No person in this firm's employment has the authority to make or give any representation or warranty in respect of the property.

