



2 bed maisonette to buy in NE37

Neville Court, Sulgrave, Washington, Tyne and Wear, NE37 3DY

£26,000 Starting Bid

🏠 x2 🚗 x1 🚻 x1

Tenure

Leasehold

On Street parking

Property features

- ✓ Ideal Investment Opportunity
- ✓ Long Term Tenant In Situ - £352 Achieving PCM
- ✓ Two Bedrooms
- ✓ Upper Floor Maisonette
- ✓ EPC Rating C

Key Information

- ✓ Council Tax: Band A
- ✓ EPC Rating: C
- ✓ Heating supply: Gas

Description

TO BE SOLD VIA ONLINE AUCTION. FEES APPLY

****LONG TERM TENANT IN SITU**TWO BEDROOMS** UPPER FLOOR MAISONETTE**PRIVATE BALCONY****

Pattinson Estate Agents are delighted to bring to the market this well presented two bedroom apartment, located in Marlborough Park, Sulgrave. Situated close to a range of local schools and amenities, Neville Court is well located within walking distance to local schools and a short drive to The Galleries Shopping Centre.

In brief this deceptively spacious apartment consists of:- Private entrance/hallway, bedroom two, open plan lounge/kitchen and a private balcony. To the first floor lies bedroom one and a three piece bathroom, externally there is a private balcony, secure intercom entry system, communal gardens and on street parking.

Early viewings are highly recommended to appreciate this investment opportunity, please call the Houghton branch to arrange a viewing.

Council Tax Band: A

Tenure: Leasehold

Length of Lease: 100

Annual Ground Rent Amount: £10.00

Annual Service Charge Amount: £1,535.00

Price: Starting Bid £26,000

Property Type: Maisonette

Parking: On Street

Heating: Gas

Entrance/Porch

Private entrance leading to the porch, the gives access to the hallway.

Lounge

Spacious lounge with an open flow to the kitchen and access to a private balcony.

Kitchen

Fitted kitchen

Bedroom Two

Second bedroom located on the second floor.

Bedroom One

Bedroom one located on the first floor.

Bathroom

Fitted bathroom

External

There is a private balcony, communal grounds and on street parking.



Ground Floor

Floor area 40.1 sq.m. (432 sq.ft.) approx

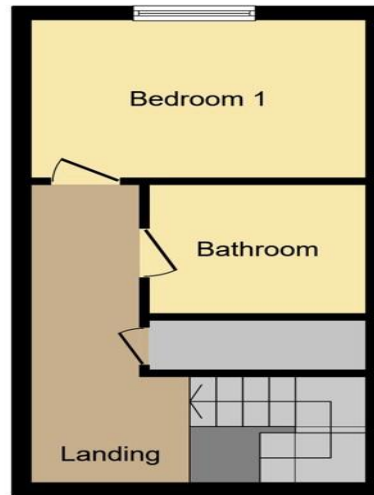

First Floor

Floor area 28.0 sq.m. (302 sq.ft.) approx

Total floor area 68.2 sq.m. (734 sq.ft.) approx

This plan is for illustration purposes only and may not be representative of the property. Plan not to scale. Powered by PropertyBox

Powered by Focal

Energy Efficiency Rating		
	Current	Potential
<i>Very energy efficient - lower running costs</i>		
(92-100) A		
(81-91) B		
(69-80) C	75	78
(55-68) D		
(39-54) E		
(21-38) F		
(1-20) G		
<i>Not energy efficient - higher running costs</i>		
England, Scotland & Wales	EU Directive 2002/91/EC	

Neville Court, Sulgrave, Washington, Tyne and Wear, NE37 3DY

Contact your local branch today for more information on this property:
G&T Properties Dudley Road, Brierley Hill, West Midlands, DY5 1HA,
<https://www.gandtproperties.co.uk/>

These particulars, whilst believed to be accurate are set out as a general outline only for guidance and do not constitute any part of an offer or contract. Intending purchasers should not rely on them as statements of representation of fact, but must satisfy themselves by inspection or otherwise as to their accuracy. No person in this firm's employment has the authority to make or give any representation or warranty in respect of the property.

